

# MONTPELIER PARK

PHOTOGRAPHS SHOWING EXISTING PARK FEATURES

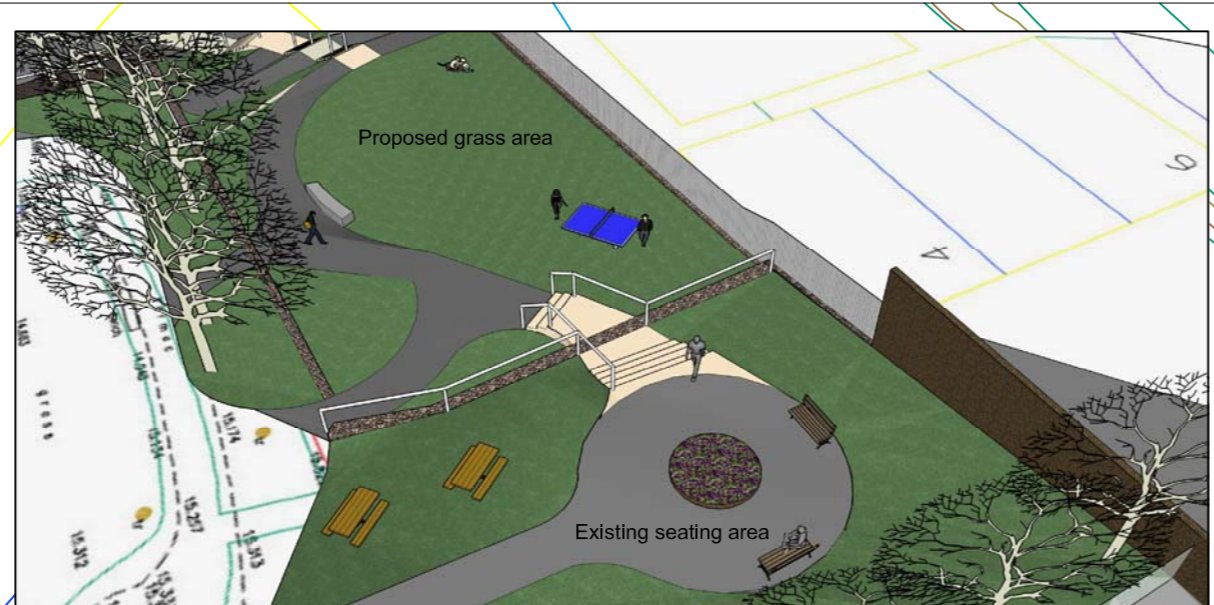

3D MODEL VISUALISATION SHOWING THE PROPOSED GRASS AREA



3D MODEL VISUALISATION SHOWING THE CONNECTION BETWEEN THE EXISTING SEATING AREA AND PROPOSED GRASS AREA



Existing telephone kiosk to be removed

Existing seats to remain

Existing gates to remain



Existing retaining curved wall to be demolished



3D MODEL VISUALISATION SHOWING THE PROPOSED STEP / RAMP ACCESS FROM THE PROPOSED 'SKATEABLE' SPACE TO THE PROPOSED GRASS AREA

Install additional dog bins at locations to be agreed

Proposed metal hand rail 800mm above GL  
 Proposed retaining wall built to raise existing level of the grass area by approx. 1000mm. Existing fencing to be re-installed on top of the proposed wall.  
 Proposed concrete games table

Proposed concrete bbq stands

Proposed bitmac ramp with landing points and PCC Pin Kerb Edgings, max. 1 in 12 ramp

Possible location of community planting areas

Proposed retaining wall max. 1000mm above GL

Proposed 'skateable' space to include; quarter pipe & 'T' block with metal edges. Surface to be a concrete float finish

Proposed steps with a 150mm riser, 400mm tread, central metal hand rail and resin bound surface with conservation kerb edgings

Proposed permanent electricity supply hook up

Existing Multi Use Games Area (M.U.G.A.)  
 - to be leveled and re surfaced in bitmac  
 - to receive new perimeter 2400mm high fencing  
 - to have new multi use goal end units including, basketball hoop, cricket wickets and goals installed  
 - to receive new court markings

Proposed line of new perimeter weld mesh fencing 3000mm high colour (RAL) 6005 Green.

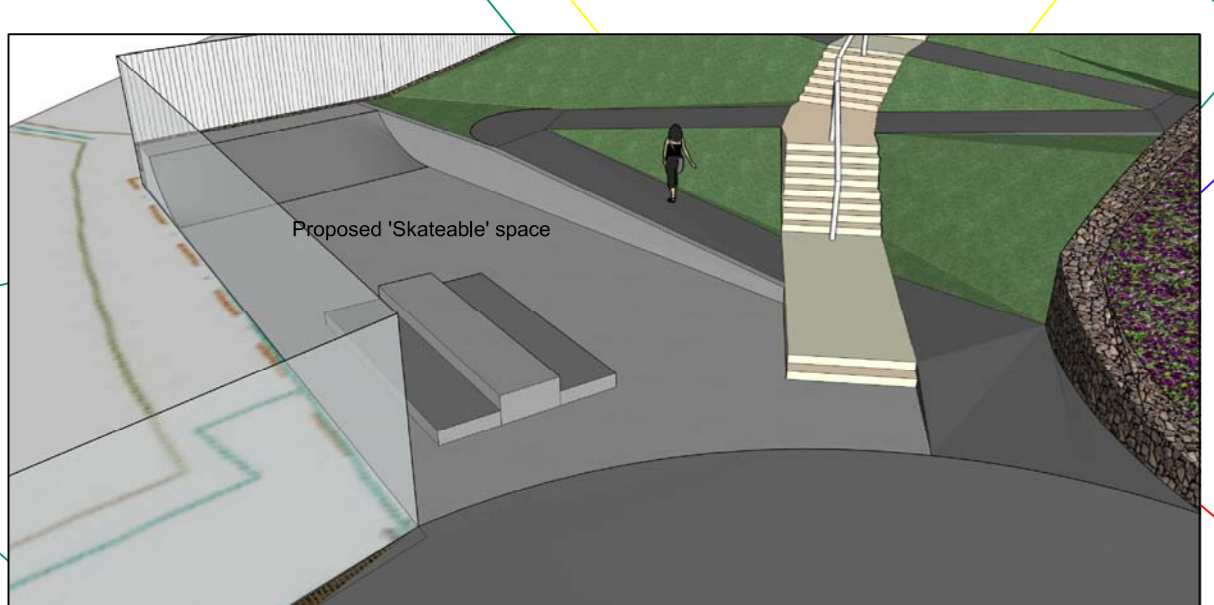

3D MODEL VISUALISATION SHOWING THE PROPOSED SKATEABLE SPACE AREA

In order to achieve a level M.U.G.A. we need to raise the existing bitmac level by approx. 1000mm in this bottom corner. This will be achieved by building a retaining wall along the perimeter of the M.U.G.A. where necessary spreading the level change across the whole area as shown in the 3D model visualisation in the bottom right corner of this page.

Old Vicarage

ST ANDREW'S ROAD

**PHASE ONE**  
 (Proposed central grass area)

**PHASE FOUR**

**PHASE TWO**  
 (Proposed spectator seating and access steps)

**PHASE THREE**  
 Existing Multi Use Games Area (M.U.G.A.)

Existing play area to remain as is

Existing tree trunk and canopy

Existing seats to remain

Proposed steps to access grass area from existing seating area

Proposed wooden picnic benches

Proposed self closing pedestrian access gate

Proposed main route through park to be lit

Proposed dual purpose bench / skate facility

Proposed self closing pedestrian access gate

Existing trees to be crown lifted, removal of any saplings / tree weed. Open up site lines and increase light levels in the park

Existing tree trunk and canopy

Proposal to clear the existing vegetation, shrubs, trees, saplings in this area and open up views across the park creating a feeling of connection between the spaces

Proposed self closing pedestrian access gate

Proposed wild flower planting

Existing vehicular gates to remain

Proposed installation of 7x no. metal drop bollards

Existing trees to remain, undergrowth to be cleared and replanted with perennial mix by local community

Proposed spectator seating and access steps with max. 800mm high hand rail. Construct steps on top of existing retaining structure, 150mm riser, 400mm tread. Install hardwood oak timber sleepers 500mm high to create spectator seats and platforms from timber retaining edge, pegs and compacted gravel surface. Bottom step to be concrete with a smooth float finish, a dual purpose step / skate facility.



3D MODEL VISUALISATION SHOWING THE PROPOSED SPECTATOR SEATING / STEPS CONNECTING THE M.U.G.A. WITH THE EXISTING PLAY AREA



3D MODEL VISUALISATION SHOWING THE PROPOSED LEVELED M.U.G.A.

Revision No. Revision Date

**BRISTOL CITY COUNCIL**  
 Landscape Design Team  
 City Development  
 Bristol House, St George's Road, Bristol BS1 5UY. Tel: 0117 922306 Fax: 0117 922 4637

**MONTPELIER PARK**

Project No. Landscape Masterplan Phasing Plan Dwg. 16.09.10  
 Drawn by AS  
 Checked by MD  
 Date of Issue 17/200@A1  
 Drawing Status CONSTRUCTION  
 Project No. LD-08/070  
 Drawing No. 4002

Do not scale off this drawing. Check all measurements on site.

This map is reproduced from Ordnance Survey material with the permission of Ordnance Survey on behalf of the Controller of Her Majesty's Stationery Office (c) Crown copyright. Unauthorised reproduction infringes Crown copyright and may lead to prosecution or civil proceedings. Bristol City Council 100023406.2010